

**NOTES: UNLESS OTHERWISE SPECIFIED:**

1. INSTALLATION PRINT INTENDED SOLELY FOR USER INFORMATION TO CONCEPTUALLY DESIGN INTO VEHICLE
2. TRIPOD HOUSINGS REQUIRE USE OF SMALL TRE TRIPOD, P/N INV-02002011, PURCHASED SEPARATELY

REVISIONS				
ZONE	REV.	DESCRIPTION	DATE	APPROVED

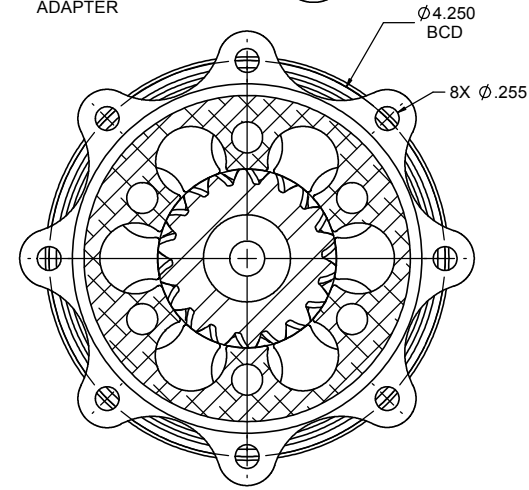
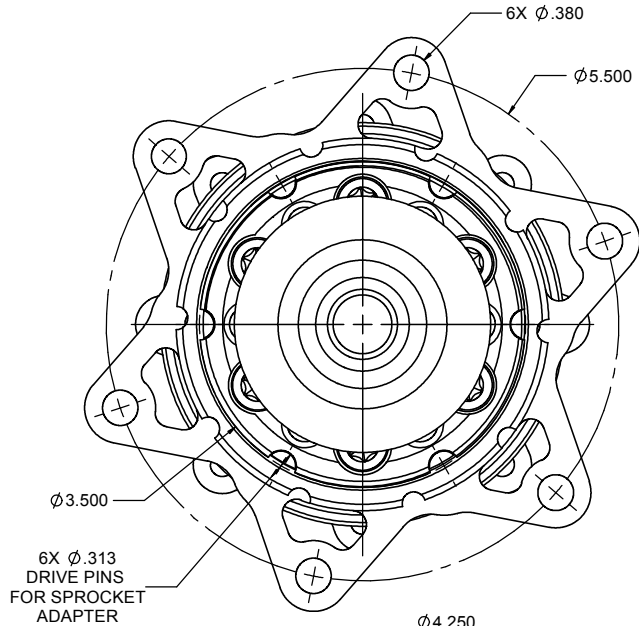

6X Ø.313  
DRIVE PINS  
FOR SPROCKET  
ADAPTER

LOCKING NUT MUST BE EITHER  
SAFETY WIRED OR PINNED  
TO END BELL FOR  
ANTI-ROTATION CONTROL

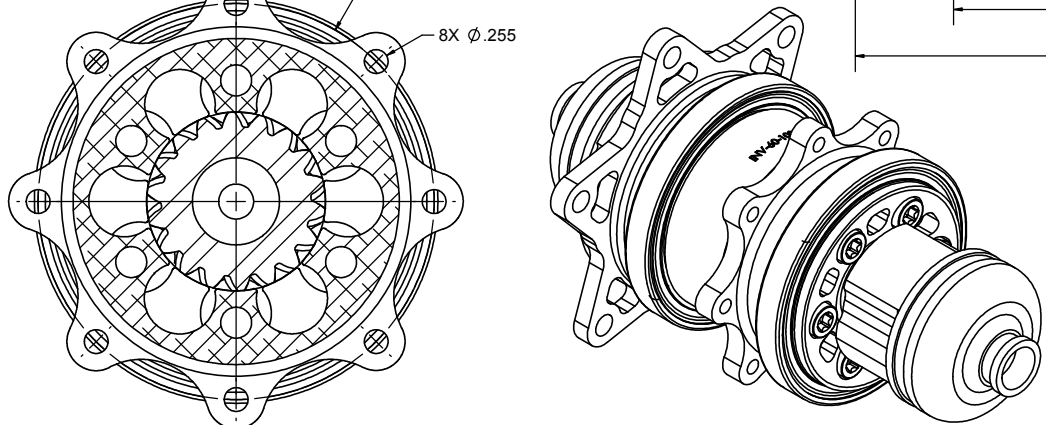
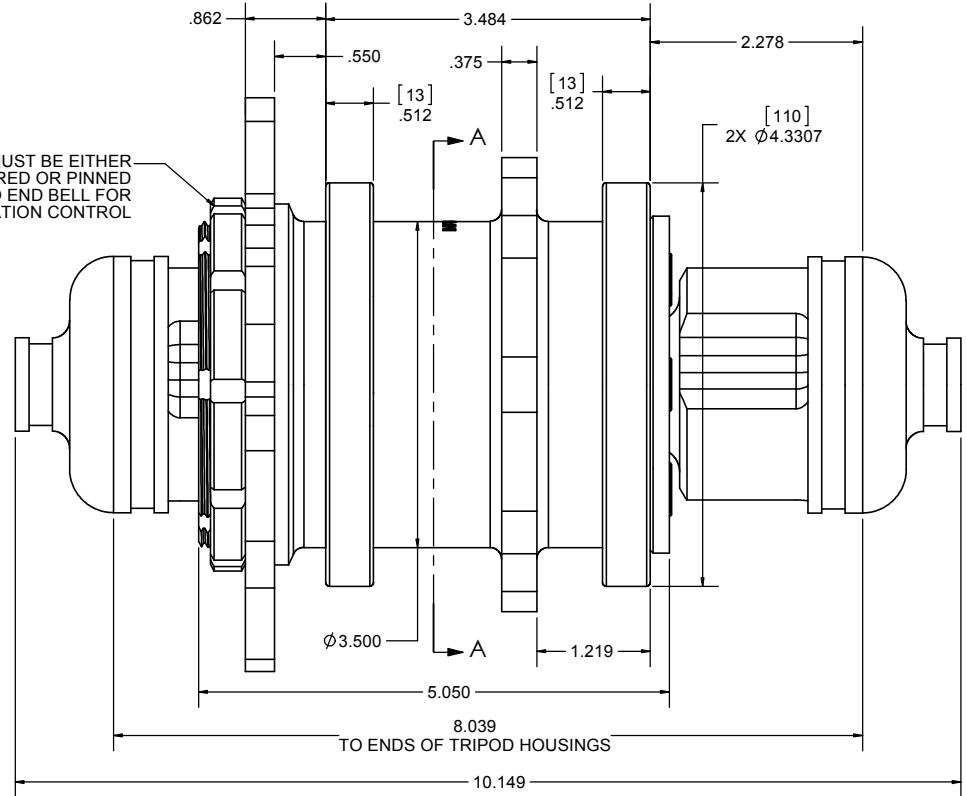

SECTION A-A

	NAME	DATE
DRAWN		
CHECKED		
APPROVED		
THIRD ANGLE PROJECTION		
<small>UNLESS OTHERWISE SPECIFIED: INTERPRET GD&amp;T PER ASME Y14.5M-2009 DIMENSIONS ARE IN INCHES: DIMENSIONS IN [XX] ARE MILLIMETERS BREAK ALL SHARP EDGES 0.005-0.015 RADIUS INSIDE CORNERS 0.032 MAX SURFACE TEXTURE: 63 µin MAX TOLERANCES: LINEAR: ± 0.005 ANGLES: ± 1.0° MATERIAL: FINISH:</small>		
<small>PROPRIETARY AND CONFIDENTIAL THE INFORMATION CONTAINED IN THIS DRAWING IS THE SOLE PROPERTY OF TAYLOR RACE ENGINEERING, LLC. ANY REPRODUCTION IN PART OR AS A WHOLE WITHOUT THE WRITTEN PERMISSION OF TAYLOR RACE ENGINEERING, LLC IS STRICTLY PROHIBITED.</small>		
DO NOT SCALE DRAWING		

**Taylor**  
RACE ENGINEERING [www.taylor-race.com](http://www.taylor-race.com)

TITLE:  
**TRE CHAIN DRIVE DIFF MK II  
INSTALLATION PRINT**

SIZE **B** DWG. NO. INV-06-10007-Installation Print

SCALE: 3:4 WEIGHT: 8.5 lbs SHEET 1 OF 1